









# INDEX

<b>SHRINK-FIT HOLDER</b> .....	<b>4</b>
<b>HSK HOLDER</b> .....	<b>5</b>
<b>BT HOLDER</b> .....	<b>9</b>
<b>SK HOLDER</b> .....	<b>14</b>
<b>HOLDER ACCESSORIES</b> .....	<b>18</b>



# SHRINK-FIT HOLDER

■ Taper 7:24; ≤AT3.

■ Locked with internal pull stud, Precise positioning.

■ A wide clamping range (D3-D12mm) is available with different extenders, which reduces production cost and increases efficiency.

■ With superior-quality steel with good CTE. (CTE:The coefficient of thermal expansion)

■ 3° Taper-off design minimizes interference.

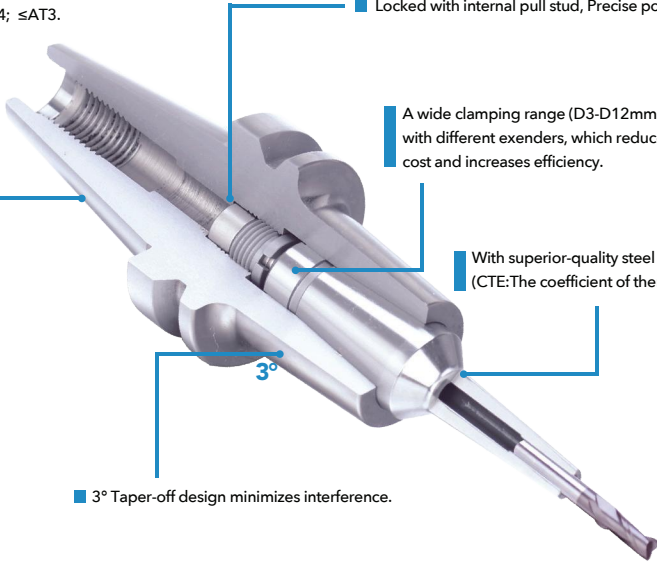

## Induction Heat Machine

Specification	Shrink time	Cooling	Voltage	Power
SF-3500	3-15"	Air Cooling	SSINGLE-PHASE 220V/25A	3500W

Tools	Range	LxWxH (mm)	Weight
Carbide	Φ3~Φ25 mm	600x500x800	41KG





## HSK-A-SF Shrink Fit Holder

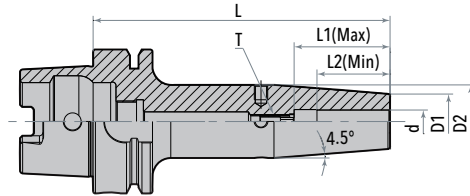

Specification	d	D1	D2	L	L1 (Max)	L2 (Min)	T	Weight
HSK50A-SF3-60	3	10	16	60	-	9	-	0.39
HSK50A-SF4-60	4	10	16	60	-	12	-	0.39
HSK50A-SF5-60	5	10	16	60	-	15	-	0.39
HSK50A-SF6-80	6	21	27	80	36	26	M050Z150-D	0.41
HSK50A-SF8-80	8	21	27	80	36	26	M050Z150-D	0.41
HSK50A-SF10-85	10	24	32	85	42	32	M060Z150-D	0.42
HSK50A-SF12-90	12	24	32	90	47	37	M060Z150-D	0.43
HSK50A-SF14-90	14	27	34	90	47	37	M060Z150-D	0.43
HSK50A-SF16-95	16	27	34	95	50	40	M080Z150-P-D	0.45
HSK63A-SF3-80	3	10	16	80	-	9	-	0.50
HSK63A-SF4-80	4	10	16	80	-	12	-	0.60
HSK63A-SF5-80	5	10	16	80	-	15	-	0.70
HSK63A-SF6-80	6	21	27	80	36	26	M050Z150-D	0.80
HSK63A-SF6-130	6	21	27	130	36	26	M050Z150-D	1.00
HSK63A-SF6-160	6	21	27	160	36	26	M050Z150-D	1.20
HSK63A-SF6-200	6	21	27	200	36	26	M050Z150-D	1.40
HSK63A-SF8-80	8	21	27	80	36	26	M050Z150-D	0.80
HSK63A-SF8-130	8	21	27	130	36	26	M050Z150-D	1.02
HSK63A-SF8-160	8	21	27	160	36	26	M050Z150-D	1.25
HSK63A-SF8-200	8	21	27	200	36	26	M050Z150-D	1.43
HSK63A-SF10-85	10	24	32	85	42	32	M060Z150-D	0.90
HSK63A-SF10-130	10	24	32	130	42	32	M060Z150-D	1.17
HSK63A-SF10-160	10	24	32	160	42	32	M060Z150-D	1.45
HSK63A-SF10-200	10	24	32	200	42	30	M060Z150-D	1.75

See next page



## HSK HOLDER

### HSK-A-SF Shrink Fit Holder

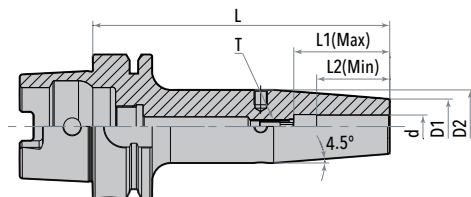

Specification	d	D1	D2	L	L1 (Max)	L2 (Min)	T	Weight
HSK63A-SF12-90	12	24	32	90	47	37	M060Z150-D	0.92
HSK63A-SF12-130	12	24	32	130	47	37	M060Z150-D	1.15
HSK63A-SF12-160	12	24	32	160	47	37	M060Z150-D	1.55
HSK63A-SF12-200	12	24	32	200	47	37	M060Z150-D	1.92
HSK63A-SF14-90	14	27	34	90	47	37	M060Z150-D	0.95
HSK63A-SF14-130	14	27	34	130	47	37	M060Z150-D	1.18
HSK63A-SF14-160	14	27	34	160	47	37	M060Z150-D	1.60
HSK63A-SF14-200	14	27	34	200	47	37	M060Z150-D	1.98
HSK63A-SF16-95	16	27	34	95	50	40	M080Z150-P-D	1.00
HSK63A-SF16-130	16	27	34	130	50	40	M080Z150-P-D	1.21
SHSK63A-F16-160	16	27	34	160	50	40	M080Z150-P-D	1.65
HSK63A-SF16-200	16	27	34	200	50	40	M080Z150-P-D	2.05
HSK63A-SF18-95	18	33	42	95	50	40	M080Z150-P-D	1.05
HSK63A-SF18-130	18	33	42	130	50	40	M080Z150-P-D	1.25
HSK63A-SF18-160	18	33	42	160	50	40	M080Z150-P-D	1.70
HSK63A-SF18-200	18	33	42	200	50	40	M080Z150-P-D	2.10
HSK63A-SF20-100	20	33	42	100	52	42	M080Z150-P-D	1.20
HSK63A-SF20-130	20	33	42	130	52	42	M080Z150-P-D	1.49
HSK63A-SF20-160	20	33	42	160	52	42	M080Z150-P-D	1.80
HSK63A-SF20-200	20	33	42	200	52	42	M080Z150-P-D	2.20
HSK63A-SF25-115	25	44	53	115	58	48	M160Z150-P-D	1.98
HSK63A-SF25-160	25	44	53	160	58	48	M160Z150-P-D	2.10
HSK63A-SF25-200	25	44	53	200	58	48	M160Z150-P-D	2.25
HSK63A-SF32-120	32	44	53	120	58	48	M160Z150-P-D	2.10
HSK63A-SF32-160	32	44	53	160	58	48	M160Z150-P-D	2.60
HSK63A-SF32-200	32	44	53	200	58	48	M160Z150-P-D	2.80

See next page 



## HSK-A-SF Shrink Fit Holder

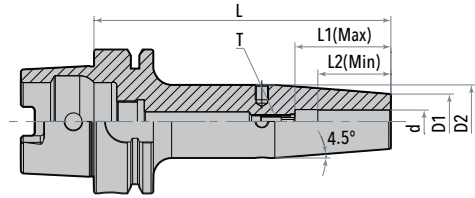

Specification	d	D1	D2	L	L1 (Max)	L2 (Min)	T	Weight
HSK100A-SF6-85	6	21	27	85	36	26	M050Z150-D	2.00
HSK100A-SF6-130	6	21	27	130	36	26	M050Z150-D	2.30
HSK100A-SF6-160	6	21	27	160	36	26	M050Z150-D	2.62
HSK100A-SF6-200	6	21	27	200	36	26	M050Z150-D	2.90
HSK100A-SF8-85	8	21	27	85	36	26	M050Z150-D	2.00
HSK100A-SF8-130	8	21	27	130	36	26	M050Z150-D	2.30
HSK100A-SF8-160	8	21	27	160	36	26	M050Z150-D	2.65
HSK100A-SF8-200	8	21	27	200	36	26	M050Z150-D	2.93
HSK100A-SF10-90	10	24	32	90	42	32	M060Z150-D	2.20
HSK100A-SF10-130	10	24	32	130	42	32	M060Z150-D	2.40
HSK100A-SF10-160	10	24	32	160	42	32	M060Z150-D	2.70
HSK100A-SF10-200	10	24	32	200	42	32	M060Z150-D	3.10
HSK100A-SF12-95	12	24	32	95	47	37	M060Z150-D	2.30
HSK100A-SF12-130	12	24	32	130	47	37	M060Z150-D	2.50
HSK100A-SF12-160	12	24	32	160	47	37	M060Z150-D	2.75
HSK100A-SF12-200	12	24	32	200	47	37	M060Z150-D	3.15
HSK100A-SF14-95	14	27	34	95	47	37	M060Z150-D	2.35
HSK100A-SF14-130	14	27	34	130	47	37	M060Z150-D	2.60
HSK100A-SF14-160	14	27	34	160	47	37	M060Z150-D	2.85
HSK100A-SF14-200	14	27	34	200	47	37	M060Z150-D	3.25
HSK100A-SF16-100	16	27	34	100	50	40	M080Z150-P-D	2.50
HSK100A-SF16-130	16	27	34	130	50	40	M080Z150-P-D	2.80
HSK100A-SF16-160	16	27	34	160	50	40	M080Z150-P-D	3.13
HSK100A-SF16-200	16	27	34	200	50	40	M080Z150-P-D	3.35
HSK100A-SF18-100	18	33	42	100	50	40	M080Z150-P-D	2.55
HSK100A-SF18-130	18	33	42	130	50	40	M080Z150-P-D	2.85





## HSK HOLDER

### HSK-A-SF Shrink Fit Holder

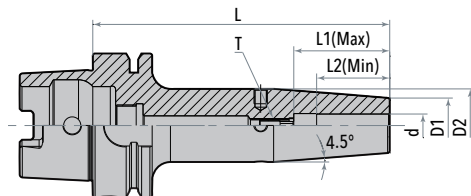

Specification	d	D1	D2	L	L1 (Max)	L2 (Min)	T	Weight
HSK100A-SF18-160	18	33	42	160	50	40	M080Z150-P-D	3.21
HSK100A-SF18-200	18	33	42	200	50	40	M080Z150-P-D	3.45
HSK100A-SF20-105	20	33	42	105	52	42	M080Z150-P-D	2.60
HSK100A-SF20-130	20	33	42	130	52	42	M080Z150-P-D	2.90
HSK100A-SF20-160	20	33	42	160	52	42	M080Z150-P-D	3.25
HSK100A-SF20-200	20	33	42	200	52	42	M080Z150-P-D	3.50
HSK100A-SF25-115	25	44	53	115	58	48	M160Z150-P-D	2.80
HSK100A-SF25-160	25	44	53	160	58	48	M160Z150-P-D	3.40
HSK100A-SF25-200	25	44	53	200	58	48	M160Z150-P-D	4.50
HSK100A-SF32-120	32	44	53	120	58	48	M160Z150-P-D	3.20
HSK100A-SF32-160	32	44	53	160	58	48	M160Z150-P-D	3.60
HSK100A-SF32-200	32	44	53	200	58	48	M160Z150-P-D	4.70

### HSK-A-DSF Shrink Fit Holder

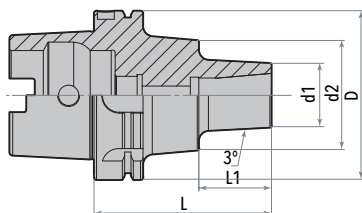

Specification	D	d1	d2	L	L1	Tension screw	Stop nut	Wrench	Weight
HSK50A-DSF12-100	50	38	-	100	74	E100Z300	ZD12-1	T06-L	0.80
HSK63A-DSF12-100	63	38	-	100	74	E100Z300	ZD12-1	T06-L	1.00
HSK63A-DSF12-135	63	38	-	135	109	E100Z300	ZD12-1	T06-L	1.70
HSK100A-DSF12-105	100	38	65	105	43	E100Z300	ZD12-1	T06-L	3.40

### Feature

1. Balanced: G2.5; 25,000 rpm;
2. Runout (X3D):  $\leq 0.003$  mm.

# BT HOLDER



## BT-SF Shrink Fit Holder

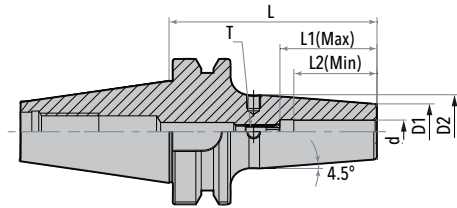

Specification	d	D1	D2	L	L1 (Max)	L2 (Min)	T	Weight
BT30-SF3-80	3	10	16	80	-	9	-	0.35
BT30-SF4-80	4	10	16	80	-	12	-	0.40
BT30-SF5-80	5	10	16	80	-	15	-	0.43
BT30-SF6-80	6	21	27	80	36	26	M050Z150-D	0.45
BT30-SF8-80	8	21	27	80	36	26	M060Z150-D	0.50
BT30-SF10-80	10	24	32	80	42	32	M060Z150-D	0.55
BT30-SF12-80	12	24	32	80	47	37	M060Z150-D	0.62
BT30-SF14-80	14	27	34	80	47	37	M060Z150-D	0.65
BT30-SF16-80	16	27	34	80	50	40	M080Z150-P-D	0.68
BT30-SF18-80	18	33	42	80	50	40	M080Z150-P-D	0.71
BT30-SF20-90	20	33	42	90	52	42	M080Z150-P-D	0.75
BT40-SF3-90	3	10	16	90	-	9	-	1.00
BT40-SF4-90	4	10	16	90	-	12	-	1.10
BT40-SF5-90	5	10	16	90	-	15	-	1.00
BT40-SF6-90	6	21	27	90	36	26	M050Z150-D	1.15
BT40-SF6-130	6	21	27	130	36	26	M050Z150-D	1.20
BT40-SF6-160	6	21	27	160	36	26	M050Z150-D	1.40
BT40-SF6-200	6	21	27	200	36	26	M050Z150-D	1.90
BT40-SF8-90	8	21	27	90	36	26	M060Z150-D	1.15
BT40-SF8-130	8	21	27	130	36	26	M060Z150-D	1.30
BT40-SF8-160	8	21	27	160	36	26	M060Z150-D	1.50
BT40-SF8-200	8	21	27	200	36	26	M060Z150-D	1.90
BT40-SF10-90	10	24	32	90	42	32	M060Z150-D	1.20
BT40-SF10-130	10	24	32	130	42	32	M060Z150-D	1.50
BT40-SF10-160	10	24	32	160	42	32	M060Z150-D	1.80
BT40-SF10-200	10	24	32	200	42	32	M060Z150-D	1.90

See next page



## BT HOLDER

### BT-SF Shrink Fit Holder

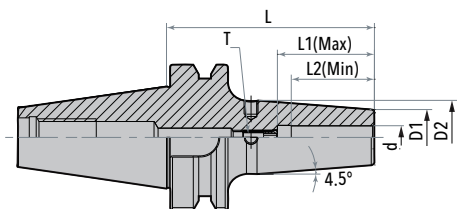

Specification	d	D1	D2	L	L1 (Max)	L2 (Min)	T	Weight
BT40-SF12-90	12	24	32	90	47	37	M080Z150-P-D	1.30
BT40-SF12-130	12	24	32	130	47	37	M080Z150-P-D	1.60
BT40-SF12-160	12	24	32	160	47	37	M080Z150-P-D	1.80
BT40-SF12-200	12	24	32	200	47	37	M080Z150-P-D	2.00
BT40-SF14-90	14	27	34	90	47	37	M080Z150-P-D	1.30
BT40-SF14-130	14	27	34	130	47	37	M080Z150-P-D	1.60
BT40-SF14-160	14	27	34	160	47	37	M080Z150-P-D	1.80
BT40-SF14-200	14	27	34	200	47	37	M080Z150-P-D	2.00
BT40-SF16-90	16	27	34	90	50	40	M080Z150-P-D	1.40
BT40-SF16-130	16	27	34	130	50	40	M080Z150-P-D	1.70
BT40-SF16-160	16	27	34	160	50	40	M080Z150-P-D	1.95
BT40-SF16-200	16	27	34	200	50	40	M080Z150-P-D	2.20
BT40-SF18-90	18	33	42	90	50	40	M080Z150-P-D	1.50
BT40-SF18-130	18	33	42	130	50	40	M080Z150-P-D	1.80
BT40-SF18-160	18	33	42	160	50	40	M080Z150-P-D	2.00
BT40-SF18-200	18	33	42	200	50	40	M080Z150-P-D	2.30
BT40-SF20-90	20	33	42	90	52	42	M080Z150-P-D	1.55
BT40-SF20-130	20	33	42	130	52	42	M080Z150-P-D	1.85
BT40-SF20-160	20	33	42	160	52	42	M080Z150-P-D	2.05
BT40-SF20-200	20	33	42	200	52	42	M080Z150-P-D	2.35
BT40-SF25-100	25	44	53	100	58	48	M160Z150-P-D	1.65
BT40-SF25-130	25	44	53	130	58	48	M160Z150-P-D	1.90
BT40-SF25-160	25	44	53	160	58	48	M160Z150-P-D	2.20
BT40-SF25-200	25	44	53	200	58	48	M160Z150-P-D	2.50
BT40-SF32-100	32	44	53	100	58	48	M160Z150-P-D	2.00
BT40-SF32-130	32	44	53	130	58	48	M160Z150-P-D	2.30
BT40-SF32-160	32	44	53	160	58	48	M160Z150-P-D	2.60



## BT-SF Shrink Fit Holder

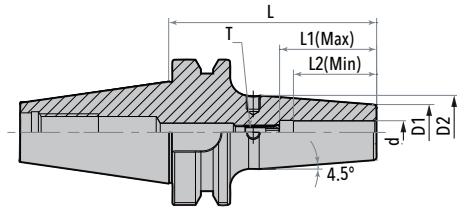

Specification	d	D1	D2	L	L1 (Max)	L2 (Min)	T	Weight
BT50-SF6-100	6	21	27	100	36	26	M050Z150-D	3.70
BT50-SF6-130	6	21	27	130	36	26	M050Z150-D	3.80
BT50-SF6-160	6	21	27	160	36	26	M050Z150-D	3.88
BT50-SF6-200	6	21	27	200	36	26	M050Z150-D	4.00
BT50-SF8-100	8	21	27	100	36	26	M060Z150-D	3.60
BT50-SF8-130	8	21	27	130	36	26	M060Z150-D	3.70
BT50-SF8-160	8	21	27	160	36	26	M060Z150-D	3.90
BT50-SF8-200	8	21	27	200	36	26	M060Z150-D	4.00
BT50-SF10-100	10	24	32	100	42	32	M060Z150-D	3.65
BT50-SF10-130	10	24	32	130	42	32	M060Z150-D	3.78
BT50-SF10-160	10	24	32	160	42	32	M060Z150-D	4.00
BT50-SF10-200	10	24	32	200	42	32	M060Z150-D	4.15
BT50-SF12-100	12	24	32	100	47	37	M080Z150-P-D	3.70
BT50-SF12-130	12	24	32	130	47	37	M080Z150-P-D	3.80
BT50-SF12-160	12	24	32	160	47	37	M080Z150-P-D	4.10
BT50-SF12-200	12	24	32	200	47	37	M080Z150-P-D	4.25
BT50-SF14-100	14	27	34	100	47	37	M080Z150-P-D	3.70
BT50-SF14-130	14	27	34	130	47	37	M080Z150-P-D	3.80
BT50-SF14-160	14	27	34	160	47	37	M080Z150-P-D	4.10
BT50-SF14-200	14	27	34	200	47	37	M080Z150-P-D	4.25
BT50-SF16-100	16	27	34	100	50	40	M080Z150-P-D	3.75
BT50-SF16-130	16	27	34	130	50	40	M080Z150-P-D	3.88
BT50-SF16-160	16	27	34	160	50	40	M080Z150-P-D	4.20
BT50-SF16-200	16	27	34	200	50	40	M080Z150-P-D	4.50
BT50-SF18-100	18	33	42	100	50	40	M080Z150-P-D	3.75
BT50-SF18-130	18	33	42	130	50	40	M080Z150-P-D	3.88
BT50-SF18-160	18	33	42	160	50	40	M080Z150-P-D	4.20



## BT HOLDER

### BT-SF Shrink Fit Holder

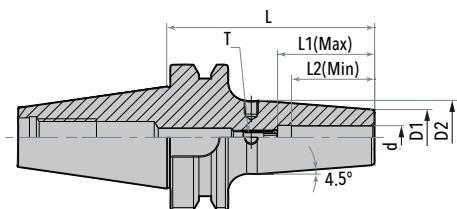

Specification	d	D1	D2	L	L1 (Max)	L2 (Min)	T	Weight
BT50-SF18-200	18	33	42	200	50	40	M080Z150-P-D	4.50
BT50-SF20-100	20	33	42	100	52	42	M080Z150-P-D	3.80
BT50-SF20-130	20	33	42	130	52	42	M080Z150-P-D	4.00
BT50-SF20-160	20	33	42	160	52	42	M080Z150-P-D	4.30
BT50-SF20-200	20	33	42	200	52	42	M080Z150-P-D	4.60
BT50-SF25-100	25	44	53	100	58	48	M160Z150-P-D	3.82
BT50-SF25-130	25	44	53	130	58	48	M160Z150-P-D	4.05
BT50-SF25-160	25	44	53	160	58	48	M160Z150-P-D	4.33
BT50-SF25-200	25	44	53	200	58	48	M160Z150-P-D	4.65
BT50-SF32-100	32	44	53	100	58	48	M160Z150-P-D	4.00
BT50-SF32-130	32	44	53	130	58	48	M160Z150-P-D	4.40
BT50-SF32-160	32	44	53	160	58	48	M160Z150-P-D	4.70
BT50-SF32-200	32	44	53	200	58	48	M160Z150-P-D	5.00

### Feature

1. Balanced: G2.5; 25,000 rpm;
2. Runout (X3D):  $\leq 0.003$  mm.



## BT-DSF Shrink Fit Holder

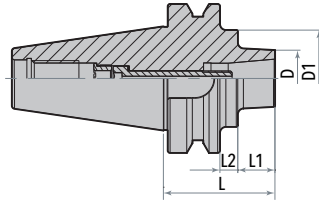

Specification	D	D1	L1	L2	L	Tension screw	Stop nut	Wrench	Weight
BT30-DSF12-60	38	-	13	-	60	E100Z300	ZD12-1	T06	0.40
BT40-DSF12-50	38	-	18	-	50	E100Z300	ZD12-1	T06	1.10
BT40-DSF12-75	38	-	48	-	75	E100Z300	ZD12-1	T06-L	1.40
BT-40-DSF12-135	41	-	108	-	135	E100Z300	ZD12-1	T06-L	2.20
BT50-DSF12-75	38	65	25	12	75	E100Z400	ZD12-1	T06-L	4.00
BT50-DSF12-105	41	65	55	12	105	E100Z700	ZD12-1	T06-L	4.40
BT50-DSF12-135	41	65	85	12	135	E100Z100	ZD12-1	T06-L	4.70

Notice:Wrench is included.

### Feature

1. Balanced: G2.5; 25,000 rpm;
2. Runout (X3D):  $\leq 0.003$  mm.



## SK HOLDER

### SK-SF Shrink Fit Holder

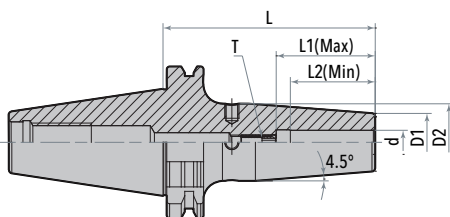

Specification	d	D1	D2	L	L1 (Max)	L2 (Min)	T	Weight
SK30-SF3-80	3	10	16	80	-	9	-	0.35
SK30-SF4-80	4	10	16	80	-	12	-	0.40
SK30-SF5-80	5	10	16	80	-	15	-	0.43
SK30-SF6-80	6	21	27	80	36	26	M050Z150-D	0.45
SK30-SF8-80	8	21	27	80	36	26	M060Z150-D	0.50
SK30-SF10-80	10	24	32	80	42	32	M060Z150-D	0.55
SK30-SF12-80	12	24	32	80	47	37	M060Z150-D	0.62
SK30-SF16-80	16	27	34	80	50	40	M080Z150-P-D	0.68
SK40-SF3-90	3	10	16	90	-	9	-	1.00
SK40-SF4-90	4	10	16	90	-	12	-	1.10
SK40-SF5-90	5	10	16	90	-	15	-	1.00
SK40-SF6-90	6	21	27	90	36	26	M050Z150-D	1.15
SK40-SF6-130	6	21	27	130	36	26	M050Z150-D	1.20
SK40-SF6-160	6	21	27	160	36	26	M050Z150-D	1.40
SK40-SF6-200	6	21	27	200	36	26	M050Z150-D	1.90
SK40-SF8-90	8	21	27	90	36	26	M060Z150-D	1.15
SK40-SF8-130	8	21	27	130	36	26	M060Z150-D	1.30
SK40-SF8-160	8	21	27	160	36	26	M060Z150-D	1.50
SK40-SF8-200	8	21	27	200	36	26	M060Z150-D	1.90
SK40-SF10-90	10	24	32	90	42	32	M060Z150-D	1.20
SK40-SF10-130	10	24	32	130	42	32	M060Z150-D	1.50
SK40-SF10-160	10	24	32	160	42	32	M060Z150-D	1.80
SK40-SF10-200	10	24	32	200	42	32	M060Z150-D	1.90
SK40-SF12-90	12	24	32	90	47	37	M080Z150-P-D	1.30
SK40-SF12-130	12	24	32	130	47	37	M080Z150-P-D	1.60
SK40-SF12-160	12	24	32	160	47	37	M080Z150-P-D	1.80
SK40-SF12-200	12	24	32	200	47	37	M080Z150-P-D	2.00

See next page

# SK HOLDER



## SK-SF Shrink Fit Holder

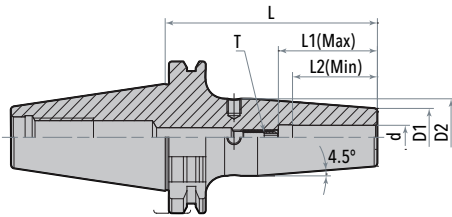

Specification	d	D1	D2	L	L1 (Max)	L2 (Min)	T	Weight
SK40-SF14-90	14	27	34	90	47	37	M080Z150-P-D	1.30
SK40-SF14-130	14	27	34	130	47	37	M080Z150-P-D	1.60
SK40-SF14-160	14	27	34	160	47	37	M080Z150-P-D	1.80
SK40-SF14-200	14	27	34	200	47	37	M080Z150-P-D	2.00
SK40-SF16-90	16	27	34	90	50	40	M080Z150-P-D	1.40
SK40-SF16-130	16	27	34	130	50	40	M080Z150-P-D	1.70
SK40-SF16-160	16	27	34	160	50	40	M080Z150-P-D	1.95
SK40-SF16-200	16	27	34	200	50	40	M080Z150-P-D	2.20
SK40-SF18-90	18	33	42	90	50	40	M080Z150-P-D	1.50
SK40-SF18-130	18	33	42	130	50	40	M080Z150-P-D	1.80
SK40-SF18-160	18	33	42	160	50	40	M080Z150-P-D	2.00
SK40-SF18-200	18	33	42	200	50	40	M080Z150-P-D	2.30
SK40-SF20-90	20	33	42	90	52	42	M080Z150-P-D	1.55
SK40-SF20-130	20	33	42	130	52	42	M080Z150-P-D	1.85
SK40-SF20-160	20	33	42	160	52	42	M080Z150-P-D	2.05
SK40-SF20-200	20	33	42	200	52	42	M080Z150-P-D	2.35
SK40-SF25-100	25	44	53	100	58	48	M160Z150-P-D	1.65
SK40-SF25-130	25	44	53	130	58	48	M160Z150-P-D	1.90
SK40-SF25-160	25	44	53	160	58	48	M160Z150-P-D	2.20
SK40-SF25-200	25	44	53	200	58	48	M160Z150-P-D	2.50
SK40-SF32-100	32	44	53	100	58	48	M160Z150-P-D	2.00
SK40-SF32-130	32	44	53	130	58	48	M160Z150-P-D	2.30
SK40-SF32-160	32	44	53	160	58	48	M160Z150-P-D	2.60
SK50-SF6-100	6	21	27	100	36	26	M050Z150-D	3.70
SK50-SF6-130	6	21	27	130	36	26	M050Z150-D	3.80
SK50-SF6-160	6	21	27	160	36	26	M050Z150-D	3.88
SK50-SF6-200	6	21	27	200	36	26	M050Z150-D	4.00

See next page





## SK HOLDER

### SK-SF Shrink Fit Holder

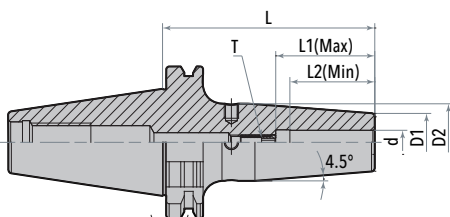

Specification	d	D1	D2	L	L1 (Max)	L2 (Min)	T	Weight
SK50-SF8-100	8	21	27	100	36	26	M060Z150-D	3.60
SK50-SF8-130	8	21	27	130	36	26	M060Z150-D	3.70
SK50-SF8-160	8	21	27	160	36	26	M060Z150-D	3.90
SK50-SF8-200	8	21	27	200	36	26	M060Z150-D	4.00
SK50-SF10-100	10	24	32	100	42	32	M060Z150-D	3.65
SK50-SF10-130	10	24	32	130	42	32	M060Z150-D	3.78
SK50-SF10-160	10	24	32	160	42	32	M060Z150-D	4.00
SK50-SF10-200	10	24	32	200	42	32	M060Z150-D	4.15
SK50-SF12-100	12	24	32	100	47	37	M080Z150-P-D	3.70
SK50-SF12-130	12	24	32	130	47	37	M080Z150-P-D	3.80
SK50-SF12-160	12	24	32	160	47	37	M080Z150-P-D	4.10
SK50-SF12-200	12	24	32	200	47	37	M080Z150-P-D	4.25
SK50-SF14-100	14	27	34	100	47	37	M080Z150-P-D	3.70
SK50-SF14-130	14	27	34	130	47	37	M080Z150-P-D	3.80
SK50-SF14-160	14	27	34	160	47	37	M080Z150-P-D	4.10
SK50-SF14-200	14	27	34	200	47	37	M080Z150-P-D	4.25
SK50-SF16-100	16	27	34	100	50	40	M080Z150-P-D	3.75
SK50-SF16-130	16	27	34	130	50	40	M080Z150-P-D	3.88
SK50-SF16-160	16	27	34	160	50	40	M080Z150-P-D	4.20
SK50-SF16-200	16	27	34	200	50	40	M080Z150-P-D	4.50
SK50-SF18-100	18	33	42	100	50	40	M080Z150-P-D	3.75
SK50-SF18-130	18	33	42	130	50	40	M080Z150-P-D	3.88
SK50-SF18-160	18	33	42	160	50	40	M080Z150-P-D	4.20
SK50-SF18-200	18	33	42	200	50	40	M080Z150-P-D	4.50
SK50-SF20-100	20	33	42	100	52	42	M080Z150-P-D	3.80
SK50-SF20-130	20	33	42	130	52	42	M080Z150-P-D	4.00
SK50-SF20-160	20	33	42	160	52	42	M080Z150-P-D	4.30

# SK HOLDER



## SK-SF Shrink Fit Holder

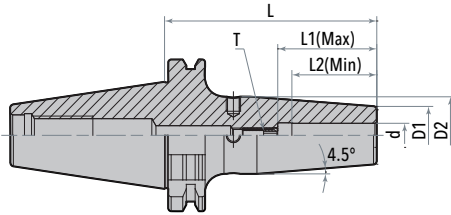

Specification	d	D1	D2	L	L1 (Max)	L2 (Min)	T	Weight
SK50-SF20-200	20	33	42	200	52	42	M080Z150-P-D	4.60
SK50-SF25-100	25	44	53	100	58	48	M160Z150-P-D	3.82
SK50-SF25-130	25	44	53	130	58	48	M160Z150-P-D	4.05
SK50-SF25-160	25	44	53	160	58	48	M160Z150-P-D	4.33
SK50-SF25-200	25	44	53	200	58	48	M160Z150-P-D	4.65
SK50-SF32-100	32	44	53	100	58	48	M160Z150-P-D	4.00
SK50-SF32-130	32	44	53	130	58	48	M160Z150-P-D	4.40
SK50-SF32-160	32	44	53	160	58	48	M160Z150-P-D	4.70
SK50-SF32-200	32	44	53	200	58	48	M160Z150-P-D	5.00

## SK-DSF Shrink Fit Holder

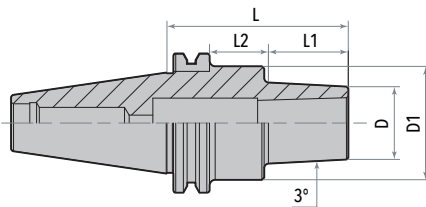

Specification	D	D1	L1	L2	L	Tension screw	Stop nut	Wrench	Weight
SK40-DSF12-45	38	-	18	-	50	E100Z300	ZD12-1	T06	1.08
SK40-DSF12-75	38	-	48	-	75	E100Z300	ZD12-1	T06-L	1.40
SK40-DSF12-135	41	-	108	-	135	E100Z300	ZD12-1	T06-L	2.20
SK50-DSF12-75	38	65	25	21	75	E100Z400	ZD12-1	T06-L	4.00
SK50-DSF12-105	41	65	55	21	105	E100Z700	ZD12-1	T06-L	4.40
SK50-DSF12-135	41	65	85	21	135	E100Z1000	ZD12-1	T06-L	4.70

Notice:Wrench is included.

### Feature

1. Balanced: G2.5; 25,000 rpm;
2. Runout (X3D):  $\leq 0.003$  mm.



## HOLDER ACCESSORIES

### DSF Shrink Fit Extender

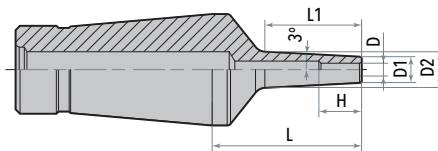

Specification	D	D1	D2	L1	L	H(Min)	H(Max)	Weight
DSF12-D3-35-1.5	3	6	8.4	22	35	10	60	0.20
DSF12-D3-55-1.5	3	6	10.5	42	55	10	80	0.20
DSF12-D3-80-1.5	3	6	13.1	67	80	10	105	0.20
DSF12-D3-110-1.5	3	6	16.2	97	110	10	135	0.20
DSF12-D3-35-2.25	3	7.5	9.9	22	35	10	60	0.20
DSF12-D3-55-2.25	3	7.5	12	42	55	10	80	0.20
DSF12-D3-80-2.25	3	7.5	14.6	67	80	10	105	0.20
DSF12-D4-35-1.5	4	7	9.4	22	35	12	60	0.20
DSF12-D4-55-1.5	4	7	11.5	42	55	12	80	0.20
DSF12-D4-80-1.5	4	7	14.1	67	80	12	105	0.20
DSF12-D4-110-1.5	4	7	17.2	97	110	12	135	0.20
DSF12-D4-35-3	4	10	12.4	22	35	12	60	0.20
DSF12-D4-55-3	4	10	14.5	42	55	12	80	0.20
DSF12-D4-80-3	4	10	17.1	67	80	12	105	0.20
DSF12-D5-35-1.5	5	8	10.4	22	35	15	60	0.20
DSF12-D5-55-1.5	5	8	12.5	42	55	15	80	0.20
DSF12-D5-80-1.5	5	8	15.1	67	80	15	105	0.20
DSF12-D5-110-1.5	5	8	18.2	97	110	15	135	0.20
DSF12-D6-35-1.5	6	9	11.4	22	35	18	60	0.20
DSF12-D6-55-1.5	6	9	13.5	42	55	18	80	0.20
DSF12-D6-80-1.5	6	9	16.1	67	80	18	105	0.20
DSF12-D6-110-1.5	6	9	19.2	97	110	18	135	0.20
DSF12-D6-35-3	6	12	14.4	22	35	18	60	0.20
DSF12-D6-55-3	6	12	16.5	42	55	18	80	0.20
DSF12-D6-80-3	6	12	19.1	67	80	18	105	0.20
DSF12-D8-35-3	8	14	16.4	22	35	25	60	0.20
DSF12-D8-55-3	8	14	18.5	42	55	25	80	0.20
DSF12-D8-80-3	8	14	21.1	67	80	25	105	0.30
DSF12-D10-35-3	10	16	18.4	22	35	30	60	0.20
DSF12-D10-55-3	10	16	20.5	42	55	30	60	0.20
DSF12-D10-80-3	10	16	23.1	67	80	30	60	0.30
DSF12-D12-35-4	12	20	22.4	22	35	30	60	0.20
DSF12-D12-55-4	12	20	24.5	42	55	30	60	0.20
DSF12-D12-80-4	12	20	25.5	-	80	30	60	0.30



## SF Shrink Fit Extender

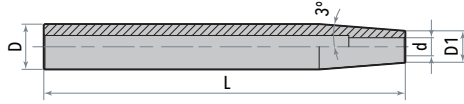

Specification	d	D2	L1 (Max)	T	Weight
C12-SF3-160	12	8	3	160	0.20
C12-SF4-160	12	8	4	160	0.21
C16-SF3-160	16	10	3	160	0.22
C16-SF4-160	16	10	4	160	0.23
C16-SF5-160	16	10	5	160	0.24
C16-SF6-160	16	10	6	160	0.25
C20-SF5-160	20	14	5	160	0.40
C20-SF6-160	20	14	6	160	0.42
C20-SF8-160	20	14	8	160	0.44
C25-SF8-160	25	20	8	160	0.60
C25-SF10-160	25	20	10	160	0.62
C25-SF12-160	25	20	12	160	0.65
C32-SF10-160	32	27	10	160	0.78
C32-SF12-160	32	27	12	160	0.81
C32-SF16-160	32	27	16	160	0.83
C32-SF20-160	32	27	20	160	0.85



# MEMO

A large rectangular area filled with a grid of small, evenly spaced dotted lines, intended for writing a memo.



FOR A BETTER US



**ADDRESS**

ROOM 1601, NO. 399 MINHE ROAD, ZHENHAI,  
NINGBO CHINA, 315202

**GET IN TOUCH**

PHONE: **+86 574 8659 2189**

FAX: **+86 574 8659 3892**

**NTOOLS2017@GMAIL.COM**

**WWW.NICHE-TOOL.COM**